

The Las Vegas Country Club is nestled in the beautiful city of Las Vegas where the backdrop to several holes pans the Las Vegas cityscape and provides a truly unique visual experience to accompany the finely manicured course.

The golf course was designed by **Ed Ault** and was completed in the Fall of 1967. It was opened under the name of The Las Vegas International Country



Club and then sold to a Strip hotel and renamed The Bonanza Country



Club and Corral and finally resold in late

1970 becoming The Las Vegas Country Club, and made into a private country club in July of 1971. The course was fully renovated in 2009 and has played host to the PGA's Las Vegas Invitational and the LPGA's Takefuji Classic in years past.

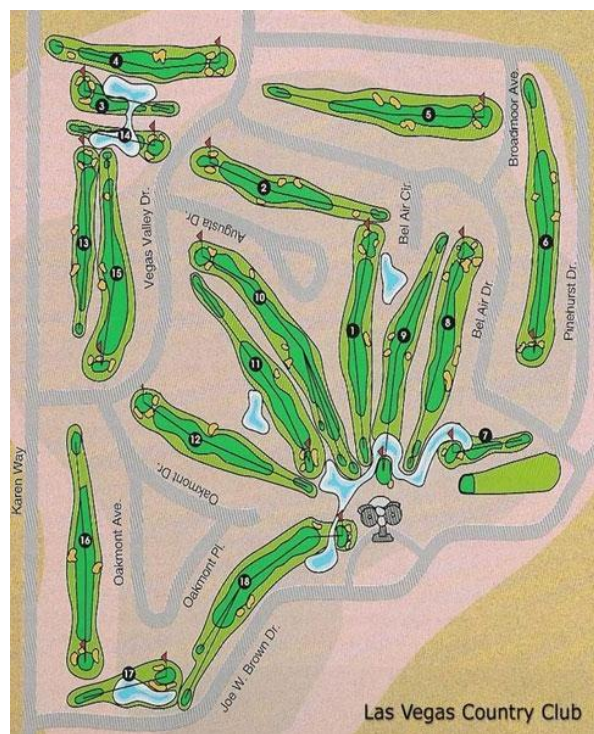



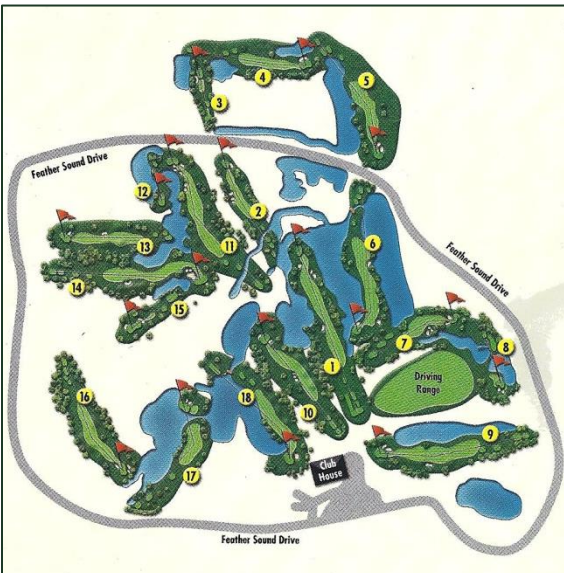

Feather Sound Country Club was designed by **Joe Lee** and updated by **Bob Cupp**. The par 72 course plays like one of the longest 6,900 yard courses you've ever played. It is not your typical Florida design in more ways than one. With an open, airy, natural feel, there isn't a place on the golf course where you feel enclosed on both sides by houses and condos, unlike almost every other course in the area. A very good test of golf, the dedicated golfer will appreciate the challenges that are offered in the well-guarded, elevated greens at Feather Sound. And by allowing the average player to swing away off the tee and offering plenty of options to every player, it's a course that can challenge and be enjoyed by players of all skill levels.

Most of the difficulty to be found at Feather Sound is around the Pinehurst-style elevated greens, the signature feature of the course. The challenge in playing well here is first in hitting these small, subtly contoured greens, and how you manage your short game once you're around those greens as well. And with new, TifEagle Bermuda greens, the course can maintain very good pace on the greens, but at the same time they're quite receptive.





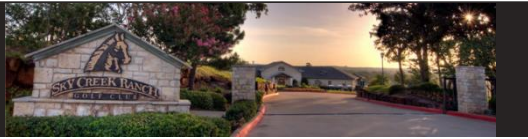

Rated 4 stars by Golf Digest's Places to Play for 2008, Sky Creek Ranch Golf Club's magnificent **Robert Trent Jones, Jr.** designed championship golf course was carved from a pristine swath of land atop the highest point in Tarrant County. Jones took full advantage of the existing topography's sweeping panoramic vistas and bounty of lush foliage to create a compelling par-72, 6,953-yard test of golf that exhilarates and delights at every turn.

Jones crafted this Texas golf gem in the old style, leaving the terrain completely natural. Offering a perfect balance of playability and strategy, the course features undulating Bermuda fairways framed by corridors of stately oak trees, including numerous doglegs; meticulously manicured, tiered bentgrass greens; an abundance of white sand bunkers; and breathtaking views. Jones' reverence for nature is evident in every rugged bend. The picturesque Big Bear Creek comes into play on 16 of the 18 holes, with numerous lakes and tributaries adding to the course's spectacular beauty...as well as its challenge.

While difficult enough to test the mettle of scratch golfers, multiple tees on each hole enable golfers of all abilities to enjoy the subtle nuances and unique design elements that have brought Jones worldwide acclaim. Among the numerous tournaments that have been held at Sky Creek Ranch Golf Club are the 2007 Texas State Public Links Championships; the 2008 Gateway Tour; the 2008 Texas Mid Amateur Qualifier; and the 2007 and 2008 U.S. Amateur Qualifier.







## La Iguana Costa Rica Golf Course

Nestled alongside an exotic rainforest with breathtaking ocean views, the 18-hole, par-72 championship La Iguana golf course offers not only a challenging **Ted Robinson**-designed layout but also a spectacular gallery featuring friendly monkeys and brightly hued macaws. Knowledgeable golf guides are happy to point out all the beautiful Costa Rica highlights. But make no mistake; the mesmerizing scenery masks a challenging course - one well worth conquering.





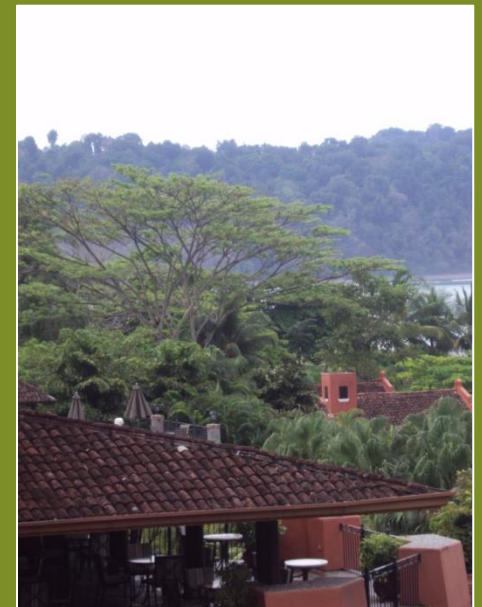
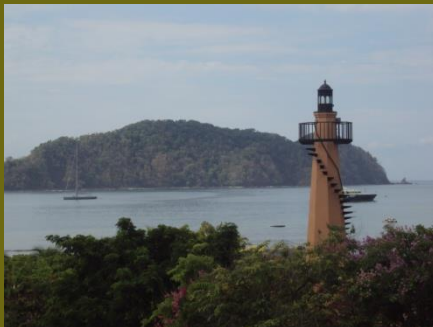
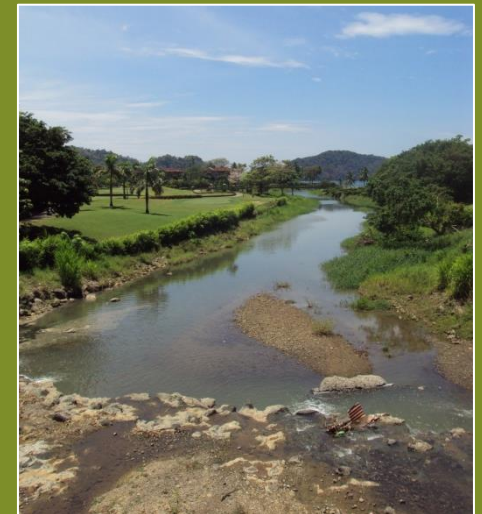



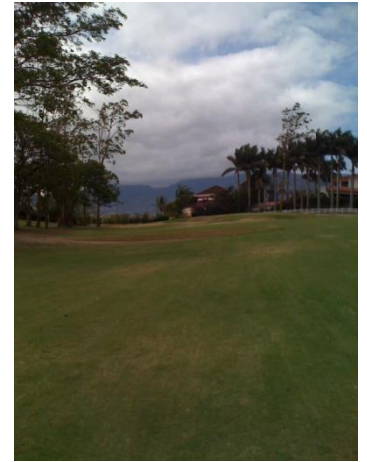
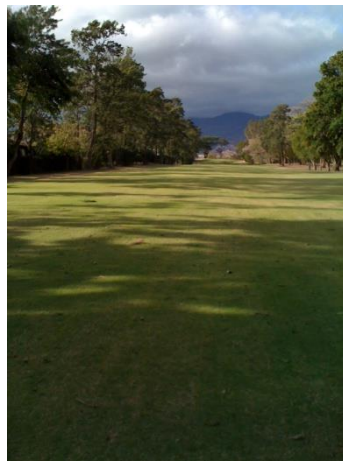

**C**ariari Country Club was founded in 1973 and was created by famed architect **George Fazio** and built by his now famous nephew, Tom Fazio. Long considered to be the best course in Central America, Cariari is a natural to play when arriving in Costa Rica. Situated on land that was once a coffee plantation, this par 71 course measures 6,577 yards from the Championship tees, but plays much longer. The course is heavily wooded, the fairways are narrow with fairway bunkers, and the greens tend to be on the large side with sand traps throughout. The Cariari has been the site of

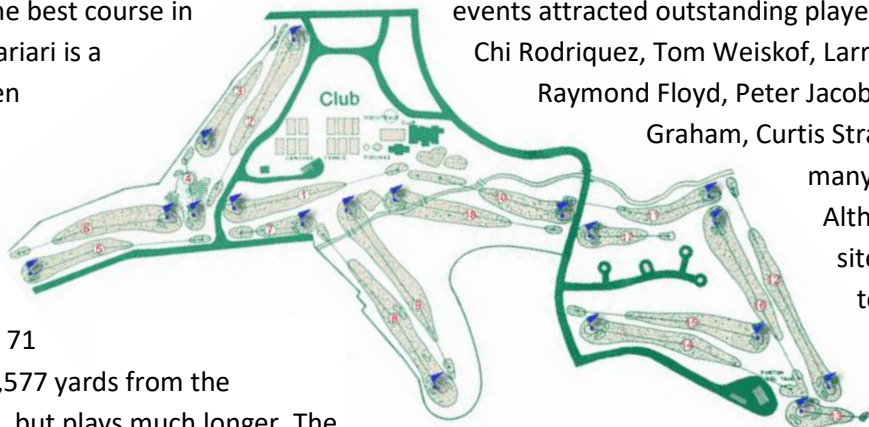

large golfing events such as the Central and South American Open, co-sponsored by the U.S. Professional Golfers Association, and the Friendship Tournament. In the past, these events attracted outstanding players like Chi-Chi Rodriquez, Tom Weiskof, Larry Ziegler, Raymond Floyd, Peter Jacobsen, David Graham, Curtis Strange, and many more.

Although the site for local tournaments is now

shared with the other 18 hole courses around the country, the Cariari still gets its share of local tournaments. Caddies are mandatory at this private course.





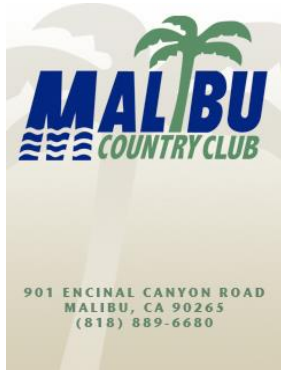

Evoking the nostalgia of golf courses built at the turn of the 20th century, the Malibu Country Club sits alone in the majestic, rolling hills of the Santa Monica Mountains. The 6614 yard **William Francis Bell** design offers 18 holes of championship golf in

one of the most breathtaking settings in all of Southern California. Only 45 minutes from downtown Los Angeles, the club enables you to escape the hustle and bustle of the city without driving for hours. The property provides the feel of a private or resort course at reasonable daily fee prices. Come discover why many consider us to be one of the best kept secrets in the golfing community. The Malibu Country Club ... how golf in Los Angeles was meant to be played!

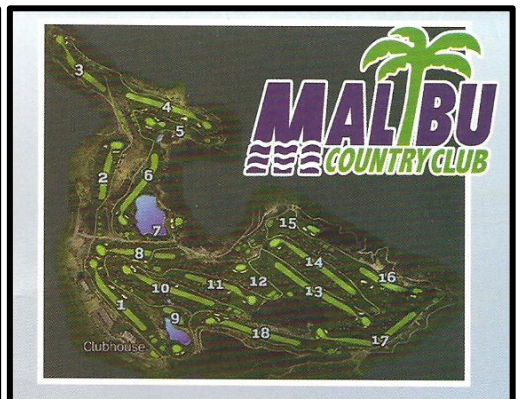
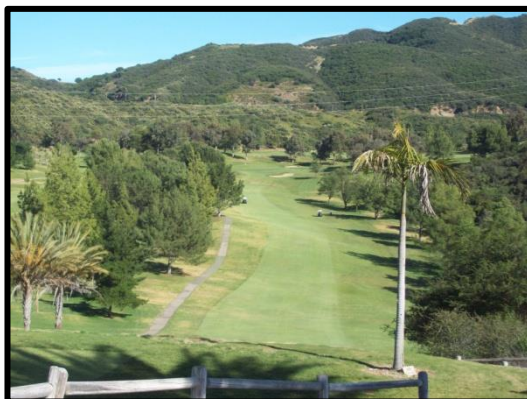





"A hidden gem" or "I had no idea it was so good" is what many of first-time players say after their first round of golf at Green Valley.

Members and Guests alike have acclaimed Green Valley Country Club for over 90 years of championship golf, elegant dining, outstanding service and superb amenities in beautiful Montgomery County, PA.

Situated on 180 rolling acres in the Greater Philadelphia area of Lafayette Hill, Green Valley offers a private, **William Flynn**-designed 18-hole championship golf course, tennis courts, an Olympic-size heated swimming pool with children's wading pool, locker room facilities for men and women, golf and tennis pro shops, exercise room and spa, two grille rooms with panoramic views of the golf course, children's dining and playrooms and adult card and game rooms.

Green Valley's classic course first opened for play in 1924. Mr. Flynn created a wonderful walking golf course over gently rolling hills on 190 acres in Lafayette Hill. Flynn referred to himself and has become known as, "The Nature Faker." At Green Valley nothing is forced and the golf course flows throughout the landscape comfortably. The result is a golf course that is playable for everyone in the family, from beginner to scratch.

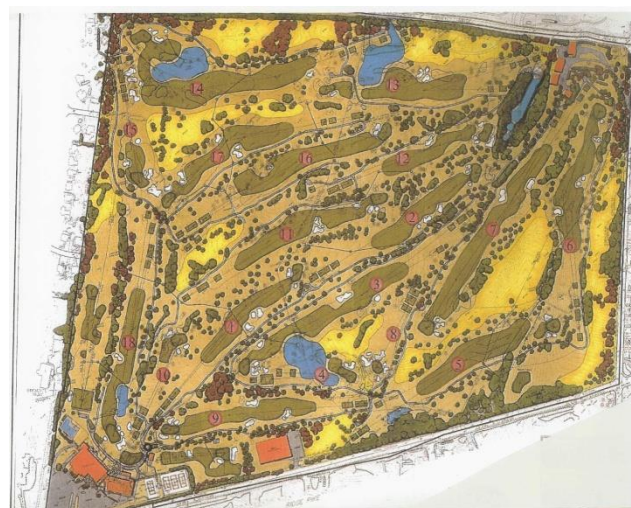





## NEWPORT NATIONAL GOLF CLUB



is the  
"BEST PUBLIC ACCESS COURSE IN RHODE ISLAND"  
- Golf Digest Magazine

Designed by legendary golf architect **Arthur Hills** and his associate Drew Rogers, the Orchard Course at Newport National Golf Club spans almost 200 acres of former shrub and tree nurseries that offer sweeping views of The Sakonnet Passage, Atlantic Ocean and Narragansett Bay.

The course features greens, tees and fairways consisting of 100% seaside bent grass, and grand, swaying fescue often exceeding 4' in length. Reminiscent of some of Ireland's finest golf links, Newport National is a unique New England golfing experience.

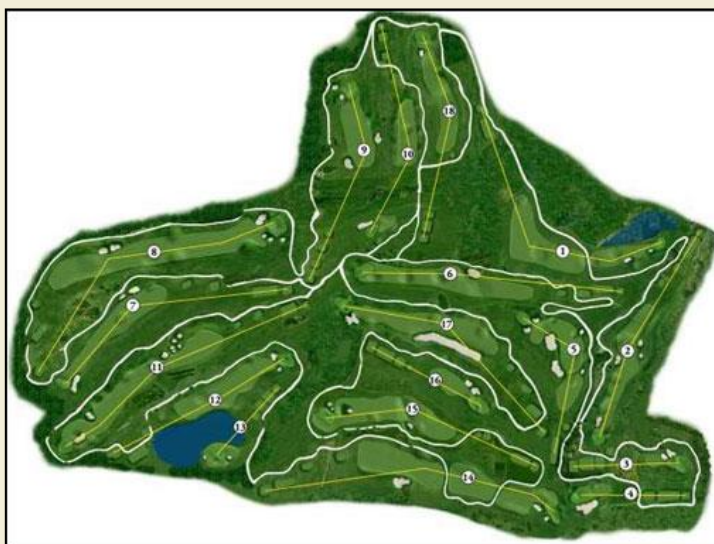





*Harbor Links*  
NORTH HEMPSTEAD, NEW YORK



Harbor Links Golf Course is an 18-hole Championship golf course located in North Hempstead, NY. The course is a reclaimed sand mine and features a bluff stabilized with teeing areas, three holes with split fairways allowing a choice of tee and entry to the greens, and more. Holes 12 & 13 sit on an area that was used for tailings from the

mine and look very similar to a western course. Designed by **Dr. Michael Hurdzan**, the course respects the environment by working around wetlands, adding tall fescues, a habitat for birds and other features. The latest turf grasses were used on fairways, greens, and rough. Harbor Links is a member of the Audubon Signature Program.







NORTH  
←



## THE COURSES AT HYLAND HILLS

18 HOLE GOLD COURSE

Hyland Hills golf course originally opened in 1963 becoming one of the first 18-hole championship golf courses in the Northern Metropolitan area. Hyland Hills hosted the 1st annual Colorado State Public Links Championship in 1965, as well as playing host to several other C.G.A. and U.S.G.A. events over the years.

In 1985 Hyland Hills golf course was redesigned by architect **Frank Hummel** becoming what is now known today as the Gold course. After being redesigned the Gold Course was awarded the 1990 United States Women's Public Links Championship.

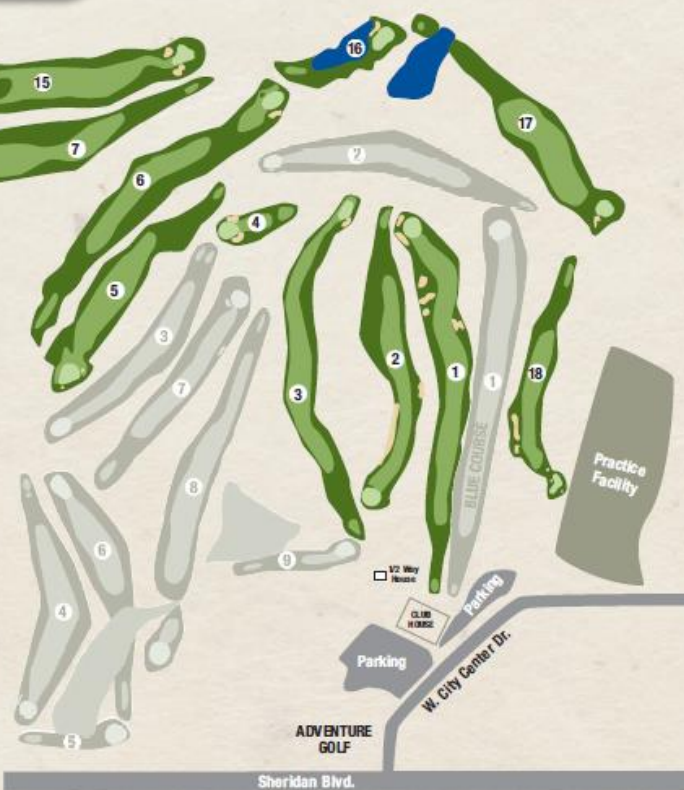





Member Site of  
**Golf Around  
the Bay**



*"Metropolitan Golf Links will test all level of players and will become a championship-links that offers a great golf experience and spectacular views of the San Francisco Bay." Johnny Miller*

What do you look for in a golf course? A chance to get away from it all? Excellent putting surfaces? Good turf? A place where you won't lose a dozen balls? A management that values walking? A fast pace of play? Service? A place that honors the traditions of the game? Fun?

The Metropolitan Golf Links is a top-notch golf facility with all the 'bells and whistles.' But the core of what makes The Metropolitan Golf Links so popular is the golf course, a **Johnny Miller** and **Fred Bliss** design just to the south of Oakland's airport. The original site boasted some gentle undulation; Miller and Bliss augmented the site and dramatically improved the drainage by covering the original landscape with two feet of sand then growing the latest turf hybrids.

In the tradition of the great links courses, The Metropolitan Golf Links is wide open. There's even some heather and clusters of native grasses to add to the ambiance. But the fairways are mostly open and the greens are large and receptive so that even the high-handicapper can get around expeditiously. Golfers who play The Metropolitan Golf Links frequently know to find the correct part of the green for their approach shots and learn to putt the undulating green surfaces. The superintendent and his staff strive, especially in the summer, to keep the course fast and firm—just the way a links course should be. And with winds coming in off San Francisco Bay, Miller and Bliss have designed the course so that the low-handicapper will have to think his or her way around the course to score well. The Metropolitan Golf Links is strong enough from the back tees to serve the needs of the Cal Bears Golf Program.

*"We like to say that the Metropolitan Golf Links is fun, fair, and forgiving."*  
**Steve Porter, PGA**







## Tiburon Golf Club

---

**Tiburon's two 18-hole championship courses are home to the Shark Shootout, which brings many of the top names in golf to this prestigious golf destination.**

A favorite of both professional and amateur golfers alike, Tiburon is carved out of 800 acres of native Florida foliage and plays like a classic links course. Golf legend and course designer **Greg Norman** blended traditional and modern elements to create an elegant and stunningly beautiful golf experience that is challenging for any player. Nowhere else will you find the combination of stacked sod-wall bunkers, approaches cut to the height of most greens, and tricky coquina waste bunkers. From your first drive to your last putt, you will find yourself at one with nature and a part of the world's ultimate golf experience... Tiburon Golf Club.



### Black Course

---

Many players come looking to tackle the Gold course, host of the Shootout. But often by the time they leave, they love the tougher, more strategic Black course.



"For the majority of people who play both courses, they think the Black is more difficult," General Manager Gary Wilcox said. "It's tighter and with more water. The Gold course, you have more room to drive the golf ball and the ability to run the ball up on greens more than the Black."

The Black is a shot-maker's dynamo. Tee shots must carve through trees that create narrow chutes, like on No. 2 and No. 17, or find fairways guarded by water on either side, like at No. 16. The water-logged, bunker-laden, par-5 ninth jump starts a fun stretch of holes added in 2002, when the complex went from 27 to 36 holes. The par-3 10th demands a long carry over water, followed by a short par 4 (359 yards from the tips) that offers birdie as a reward.



### Gold Course

---

Home of the Shark Shootout, slightly elevated greens surrounded by tricky collection areas defend the Gold course from the aerial assaults of the pros. Amateurs should copy by putting anything near the greens, Wilcox said.





"It's touchy to hit a lofted wedge off those tight lies," he said.

A round on the Gold begins in rousing style with a par 5 pinched by water and bunkers, creating a tempting, risk-reward scenario on the second shot.



The golf course features more waste bunkers, lined with crushed coquina shells, than the Black. Grounding your club is legal in these hazards, but it doesn't make the shot any easier out of their compact, sandy bottoms.





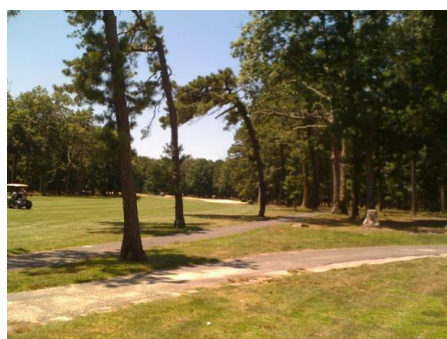
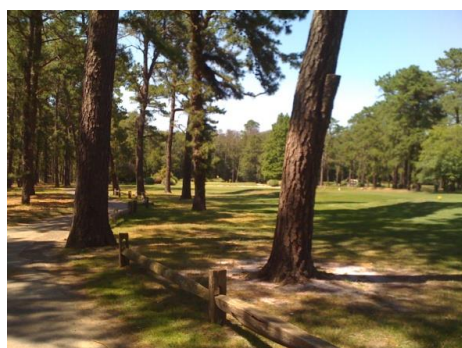
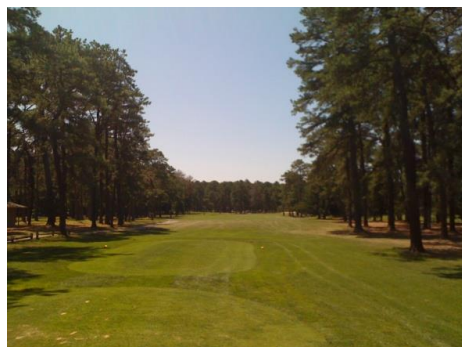
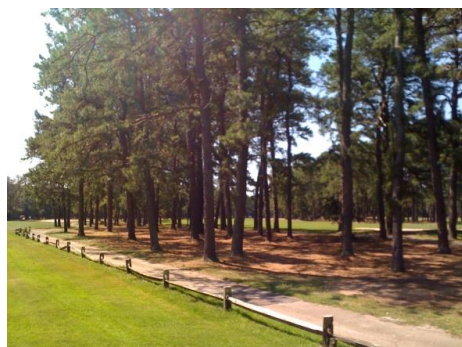

Buena Vista has emerged as a strong South Jersey favorite and was voted "Best of the Best" by readers of Powers Golf Guide. This beautiful "Carolina style" course is flat, heavily wooded and well bunkered. Water also comes into play on several holes especially on the newly

renovated par 3, 17th. The course is quite challenging and modestly priced for the experience. Designed by **William Gordon** in 1957, the course has played host to various tournaments.

### Quotes & Testimonials

What subscribers to Golf Digest's 4,200 Best Places To Play have said:

*Fun to play, well-kept secret...Pinehurst in New Jersey, best public-access course in state...Suited to above average golfer...Staff courteous...Conditions above average...Gets a lot of play throughout the year, but well kept and challenging...Tough long par 3s...Excellent pines course...Don't miss the 10th hole...Tight and long, definitely target golf...Tight fairways and lots of sand, fast hard greens, good test of skills.*

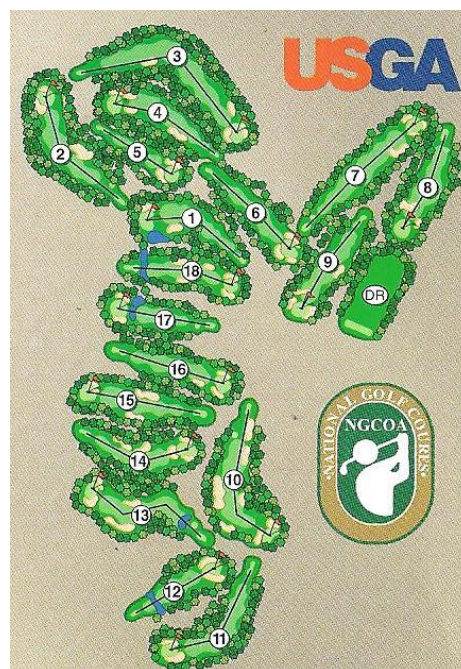



# *Fairmont* TURNBERRY ISLE

South Florida's legendary golf destination, a Mediterranean-style property set among 300 tropical acres located in Aventura, Florida, recently unveiled a stunning \$150 million transformation. World Golf Hall of Famer **Raymond Floyd** completely redesigned both championship courses from tee to green and the results are nothing short of spectacular. In doing so, he also changed the landscape of Florida golf. It's golf unlike any other in the Sunshine State with gently contoured fairways, doglegs, spectacular water features, and more elevation changes than is often seen in this part of the state.

Colorful indigenous flora and tropical trees surrounding each hole serve as a natural privacy barrier so every foursome feels like they're the only players on the course. The 18-hole Miller Course at Turnberry Isle Resort & Club originally opened in 1971. Designed by **Robert Trent Jones, Sr.**, the Miller Course at Turnberry Isle Resort & Club measures 6417 yards from the longest tees.

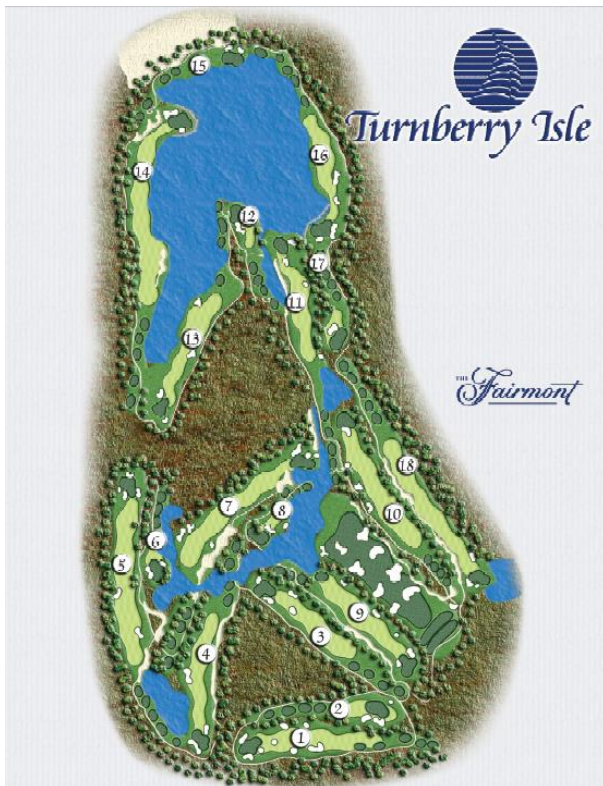
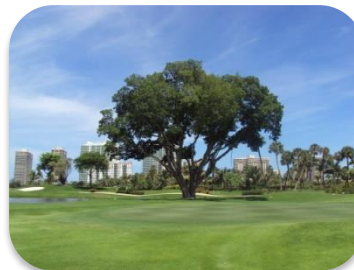





Rated four out of five stars by Golf Digest's Best Places To Play for 2010, Langdon Farms Golf Club is home to 18 holes of stunning golf designed by **John Fought** and **Robert Cupp**. Langdon Farms Golf Club opened to rave reviews in 1995 and immediately became a favorite in the Portland area. Over the years, the local, regional and even national golf writers have consistently recognized it as a truly unique golf experience. The golf facility is open, as displayed at the entrance, to the "PUBLIC ONLY" and specializes in hosting tournaments, outings and special events.

Langdon Farms Golf Club has received a "barn-load" of awards and accolades over the years. Below you'll find some of the more notable awards:

- Ranked as the "#1 best course to hold a golf tournament or corporate event in Oregon" Portland Business Journal, 2005, 2006, 2007, 2008, 2009 & 2010
- Ranked as the "#1 best public course" Portland Business Journal, 2010
- Top 10 Best Courses You Can Play In Oregon, Golfweek Magazine, Best Courses State-by-State, 2010
- Rated Four out of Five stars by Golf Digest's Best Places To Play for 2009
- Ranked #7, Top 10 "Best Courses You Can Play" in Oregon, Golfweek State by State, 2009
- Ranked as the highest rated Public Course in Oregon, Portland Business Journal, 2009
- Ranked as the "#2 public golf course in Oregon" (only behind Bandon Dunes) Portland Business Journal, 2005, 2006 & 2007
- Ranked in the Top 10 Most Challenging Courses, Portland Business Journal, 2009
- The "Big Red Barn" Clubhouse, was ranked #1 "Best New Clubhouses" by Golf Inc Magazine, 1996
- Former host site of the American Junior Golf Association
- Host of the Safeway Classic Amateur Open.



### LOCAL RULES & ETIQUETTE

USGA RULES GOVERN ALL PLAY

- ~ Non-metallic spikes only.
- ~ Out of Bounds is defined by all perimeter fencing.
- ~ Proper golf attire is required.
- ~ 150 yard markers are measured to center of green.
- ~ Cart path only on all Par 3's and Holes #4 and #15.

- ~ The red barn on hole #8 is played as an integral part of the golf course.
- ~ Replace divots, repair ballmarks and rake bunkers.
- ~ Please observe all directional signage.
- ~ Enjoy yourself and your game!

**SPEED OF PLAY:** Players must maintain their position on the course at all times. Groups falling behind may be required to skip a hole in order to maintain pace of play. All play is expected to finish in 4 hours and 15 minutes.

24377 NE AIRPORT ROAD ~ AURORA, OR 97002 ~ [www.langdonfarms.com](http://www.langdonfarms.com) ~ (503) 678-4653 (GOLF)





At much the same time as Squires was taking shape, **George Fazio** was retained to design and build a course in the Paoli area. A small group of business and professional men believed that the vigorous growth of the Upper Main Line had established the need for another family-oriented country club.

The founders located an attractive parcel of some 200 acres along Route 252 in Easttown Township, only a few miles down the road from Aronimink. The name "Waynesborough" was chosen because the site was once part of the historic Wayne estate and near the birthplace of the American Revolutionary War general, "Mad" Anthony Wayne.

Over time, Waynesborough has been able to challenge the best players in the world, while members and guests compete and enjoy the course.

Waynesborough was the host of the SEI

Pennsylvania Classic PGA Tour in 2000 and in 2002. Chris DiMarco was trampolined into one of the top players on the tour with his win in 2000. Dan Forsman was the victor in 2002. The 10th hole was statistically the fourth hardest hole on the Tour in 2000. The combination of speed and contours make the greens some of the finest on the East Coast. Waynesborough is a par 71 design, featuring four challenging, and picturesque par 3's.







### **History comes alive at "The Links"**

Just across the bay from Atlantic City's world famous Boardwalk and Casinos is the Links at Brigantine Beach. Built in 1927, 'The Links' is unique to the Northeast with its authentic Scottish links design by **Wayne Stiles** and **John Van Kleeck**. Brigantine's history is intertwined with the famed Scottish Links courses of old. Local legend suggests the "Old Pros" such as Walter Hagen and Harry Vardon played in Brigantine before setting sail for the British Open.

### **Links to the British Isles...**

True to its historic Scottish roots, this seaside layout includes breathtaking bay views, native marshes, and gently rolling nearly treeless terrain. The berms, moundings and tidal water hazards found on 14 of the 18 holes offer a challenge to all skill levels. The greens roll smoothly and are noted as the finest in Southern New Jersey... a bump-and-run strategy is often the best for producing low scores.

### **A work in progress...**

Over the past decade there have been over \$4.5 million dollars in renovations to the storied links course which has been included but not limited to: turf and bunker upgrades, new buildings, and most importantly - the restoration of the course to its original links heritage.

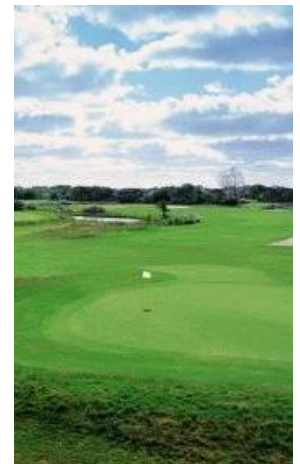
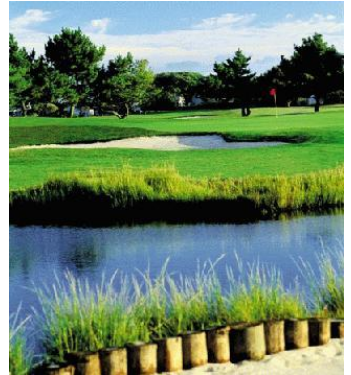



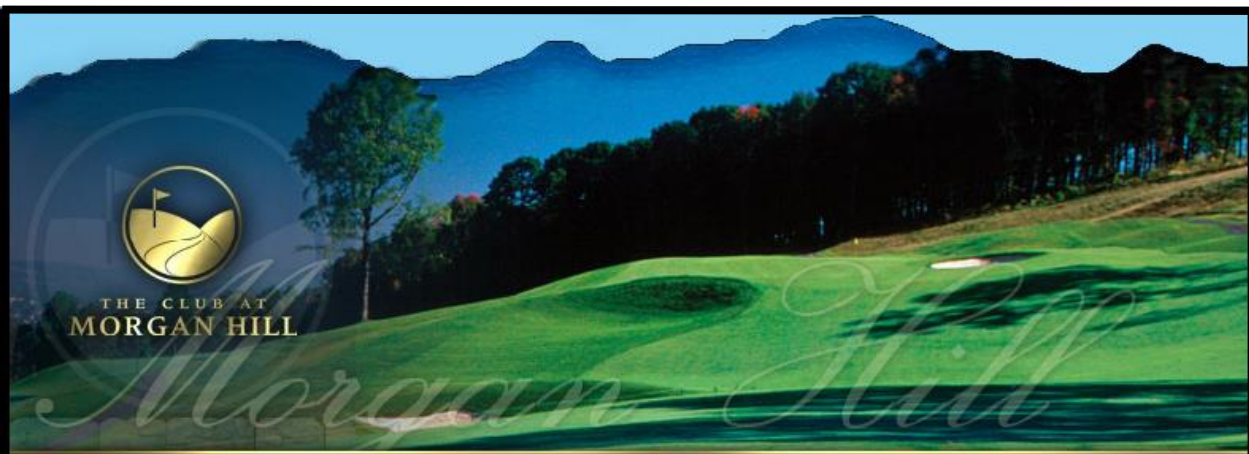

The 18-hole Club At Morgan Hill in Easton, PA opened in 2004 and measures 6749 yards from the longest tees and was designed by **Kelly Blake Moran**

This beautiful golf course is right on the border of Pennsylvania and New Jersey and offers some breathtaking views of the mountains and the Delaware river. The theme of the day at Morgan Hill is onward and upward, as every time you think you surely must be at the highest possible elevation, it seems you reach a point even higher. This culminates with the 16th green, from which you can see for literally dozens of miles.

Blind tee shots, undulating greens, pot bunkers, sand traps, wicked elevation changes, you name it, you'll have to deal with it here. The Club at Morgan Hill was named one of the "Best Places to Play," by Golf Digest in its 2008-09 edition of "Top 100 Courses You Can Play."







Located in the heart of Pottstown, Pennsylvania, adjacent to the neighborhood of Rosedale and the prestigious Hill School, Brookside Country Club provides traditional club amenities in a family friendly atmosphere. Brookside has a long and rich history.

The club's origins date back to when a group of Pottstown's leading citizens got together in June, 1916, to found a country club using the one year old Hill School course as its golfing base. The course had nine holes and it was very lightly played in summer. And the nine hole course remained untouched until the peaceful prosperity of the Eisenhower era. At that time the club bought a neighboring parcel of land and **William and**

**David Gordon**, the father-and-son team from Doylestown, would be called in to remodel the original nine and lay out a second nine.

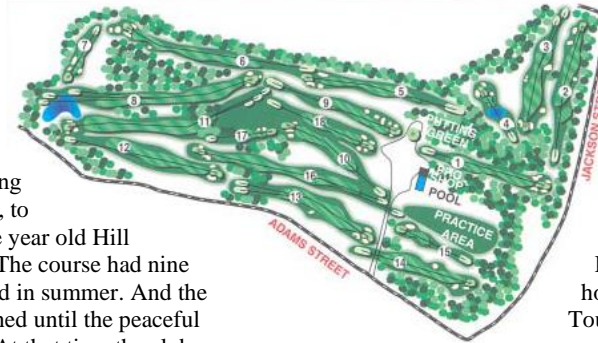

Gordon has built many well known courses including, Hawk Valley, Ocean City Golf Club and Williamsburg Country Club among others. He also worked on many redesign projects, among them is the DuPont Country Club, former home of the McDonald's LPGA Tour Championship.

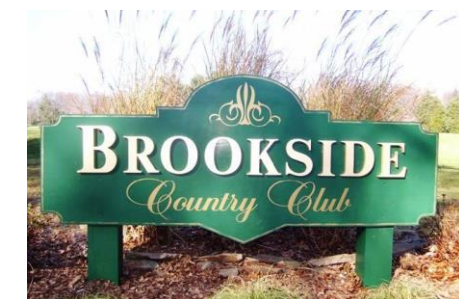





# North Hills COUNTRY CLUB



Founded in 1908, North Hills Country Club offers a welcoming haven for accomplished golfers and families. The club offers a beautiful and challenging golf course, superior swimming pools, a wealth of activities and excellent dining. Steeped in over a hundred years of tradition while stepping into the future, this club is best defined by its warm and welcoming members and staff.

The beautiful championship golf course was designed in 1908 by **J. Franklin Meehan**. It is a true old style golf course with tree lined fairways and small greens.

Originally the club was just nine holes and used a farm house just west of the present 12th hole (Oreland Swim Club parking lot) as its clubhouse. September of 1911 saw the members vote to move to a farm house located south of the 18th green. The next year, the club now having 100 restless members who were each paying \$25.00 per year dues, it was voted that North Hills should be an 18 hole course.

Meehan, who was now in his third year as president contracted to design and build the present golf course for the sum of \$1,625.00. An attempt was made to keep the old nine in use while the new layout was being constructed but the financial burden was too much. Meehan opened the new course for play on July 12, 1913, admittedly before it was ready for use.

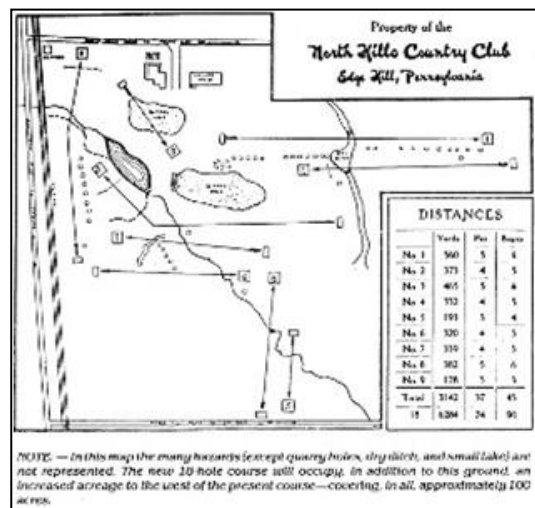





The International Golf Club & Resort is New England's Premier Golf, Dining & Lodging Destination. The International is located in picturesque Bolton, the apple capital of Massachusetts. The resort boasts two beautiful golf courses, the Pines and Oaks courses, open to members and resort guests only.

The 18-hole Pines Course opened in 1955. Designed by **Geoffrey Cornish** and **Robert Trent Jones, Sr.**, the Pines Course at International Golf Club measures 8325 yards from the longest tees and has a slope rating of 154 and a 80 USGA rating. It is ranked as the second hardest course in America by ESPN behind only Kiawah Island's Ocean Course.

It has pounded its chest as the longest golf course in the land since 1957, only once adding new back tees when someone dared to challenge its supremacy. The numbers are laughable: 8,325 yards, par 73, with a Course Rating of 80. The closing hole is 656 yards — and it's not even the longest par 5 on the course. There's also a par 6, the 715-yard fifth hole, and the par-3 seventh is 277 yards. Length isn't its only overindulgence: The fifth green is 91 yards long and takes more than an hour to mow, and the 11th, a modest 590-yard par 5, has 24 bunkers. If you plan to play it from the tips, be sure you have a three-day weekend.

The Oaks course, a superb **Tom Fazio** masterpiece, built in 2001 is a natural wonder that literally envelops the Pines course and provides a unique experience that celebrates the ebb and flow of the geography. Fazio is perhaps the most highly regarded and sought after golf course architect in the history of the game. The International has the only Tom Fazio-designed course in all of New England.

Voted into the Top Ten of America's Best New Private Courses in 2002 by *Golf Digest*, the Oaks offers a most unforgettable experience for golfers of all levels.





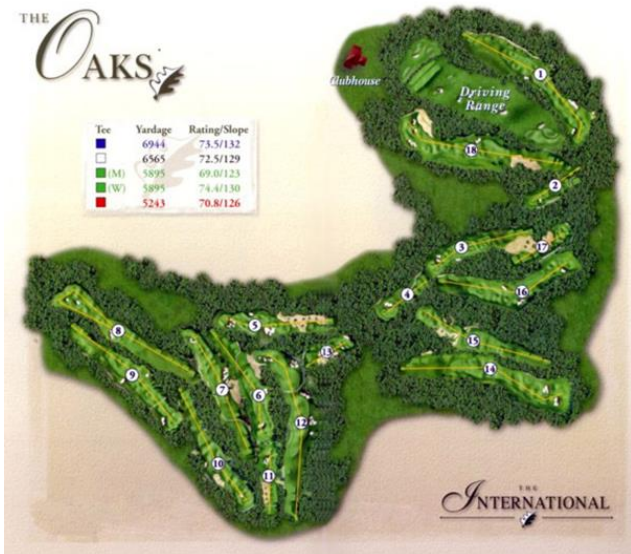



## WELCOME TO HONEYBROOK

### *Friendly, first class, affordable.*

Honeybrook Golf Club sits along the historic West Branch of the Brandywine Creek, among the Amish farms of Chester County, Pennsylvania.

The course is a mixture of wide-open links, tree-lined fairways and subtle elevation changes that combine natural beauty and a great golf layout.

Protected wetlands weave throughout to form breathtaking vistas and memorable target greens. Once you cross the creek, you'll escape from the outside world and hear nothing but the clip-clop of horse-drawn buggies and the chirping of the birds.

As for the layout, architect Jim Blaukovitch starts you out slow and easy, then works up to the good stuff. The first and second holes are simple, up-and-back par 4s that reveal little of the twists and turns to come.

Although the front nine has its moments - the fifth, a tough par 4 with a blind tee shot and long approach shot over water, is the signature hole - the best Honeybrook has to offer comes late in the outward nine and over much of the back side.

Given the terrain, it's hard to find a hole that doesn't offer some kind of elevation change, which more often than not complicates either the tee shot or the approach. The seventh, for example, plays just 336 yards from the back tee, but it's all downhill, and the short approach shot is over wild grass into a sunken, bowl-like green that is virtually blind - even after a bomb off the tee.







Quintero is rated #10 among America's private golf communities by *Golfweek* magazine. With less than 300 residences amid just over 800 acres, Quintero is a remarkably friendly, low-density community, offering unmatched beauty in the high Sonoran desert.

The course at Quintero measures 7,208 yards from the championship tees and plays to a par 72. This **Rees Jones** course is certain to test any golfer. Yet, with as many as nine tees per hole, it's also accessible to players of all skill levels. Dramatic elevation changes enhance the thrill of this desert golf masterpiece.

*Welcome to Quintero, where the land is as open as the people*

#### Course Awards:

- #3 among private courses in *Desert Golf Magazine's* 2005 Top Ten
- #10 on *Golfweek's* 2006 list of top 100 Best Residential Golf Communities
- #48 on *Golfweek's* 2006 list of top 100 Best Modern Courses

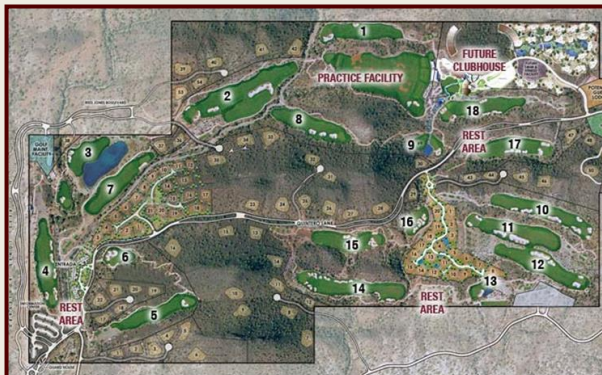
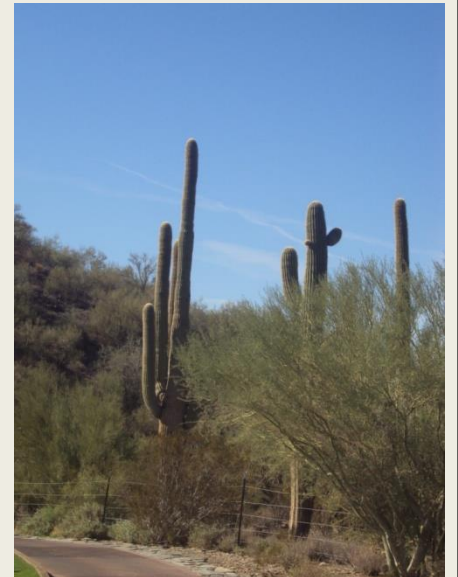





ARIZONA  
BILTMORE™

A WALDORF ASTORIA HOTEL

2400 East Missouri Avenue  
Phoenix, AZ 85016

800.950.0086 | 602.955.6600

Set in the heart of Phoenix, the Arizona Biltmore resort has been a favorite of celebrities and U.S. presidents throughout its colorful history.

Adjacent to the resort, the Arizona Biltmore Country Club boasts a challenging 36-hole design, featuring two of the premier Phoenix golf resort courses: The Adobe and The Links. Designed by **William P. Bell** and built in 1928 and restored in 2004, the Adobe offers wide fairways and classic cross-bunkers for that extra challenge. The Links features rolling fairways, desert ravines and five pristine lakes that call for a high level of sportsmanship, bold shots and demanding accuracy.

The Adobe course is considered stately and grand, a forefather of modern design. The Adobe offers a simplistic beauty hard to find in an era when trickery is a goal in golf course architecture. When you long for a relaxing yet challenging round, there are few equal. The lush, 50 year-old fairways and spacious layout are a reminder of the game the way it was meant to be - a time when graphite was for pencil lead and golf balls only came in one color. Like the great players of its day, the Adobe can tell you some stories.

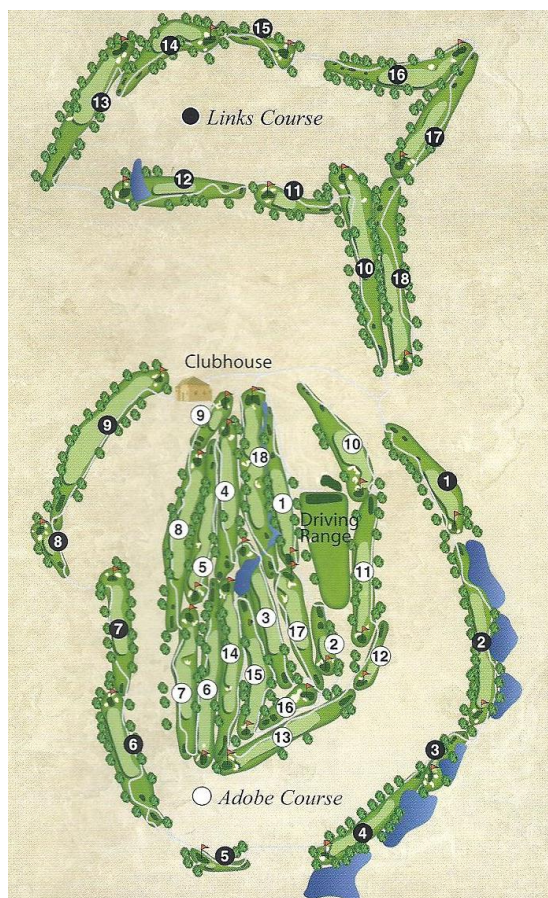





**J. Franklin Meehan** was a born entrepreneur. He loved to start something from scratch. In some instances, as at Ashbourne and SpringFord, a new golf club that had acquired ground would call him in to lay out the course, a rewarding assignment that enabled him to put his personal imprint on the raw land. But it was not quite so satisfying as conceiving the idea for a club, finding the property, laying out the course, bringing together a number of kindred souls, and actually running the club during its formative years. This he did at North Hills. And then, more than 15 years later and virtually next door, he undertook to do it again.

Originally to be called Edge Hill, Frank Meehan laid out a tight and varied 18-hole course -- the topography was rolling but not hilly, lending itself nicely to holes with an attractive naturalness about them. Scottish-born John B. Carruthers was retained as the club's first golf professional. In 1927, taking its name from the stream that runs through the property -- and today lends considerable character to the par-5 8th -- the club became Sandy Run Country Club. Frank Meehan remained in office as president until 1936, when he was succeeded by William A. Crooke.

