



He designed Shadow Creek, which has been regarded as one of the top golf courses in the world since opening in 1989 in North Las Vegas.

He oversaw renovations at historic Augusta National Golf Club before the 2002 Masters and has more credits on Golf Digest's list of America's 100 Greatest Golf Courses than any other living designer.

In fact, the Golf Digest poll for Best Modern Day Golf Course Architect was discontinued after **Tom Fazio** won the award three straight times.

"It's very different than Shadow Creek. Shadow Creek is 100 acres larger in size than Wynn," Fazio said. "Wynn will be a classic, old-style golf course. There will be distinctive golf holes and the feeling of separation of holes.

"Shadow Creek tried to disguise the outside environment, because there's not much around it. But Wynn will have a distinctive, unique feeling of an urban environment, like the Bel-Air (Country Club) in Los Angeles. On a lot of holes, people will say it reminds them of Bel-Air."

Fazio, who has been designing golf courses for 40 years, kept more than 1,000 trees from the old Desert Inn course the Wynn is replacing, but everything else will be new on the par-70, 7,042-yard layout. "The only thing that stayed was the trees, and one bridge we saved and put back," Fazio said. "The big, gigantic trees we couldn't move, we left those. The rest that we could remove we put in a nursery. Then we went in and graded the property and created 30 to 40 feet of elevation changes, and then we put the trees back. It's a new golf course, with new elevation, and old trees."

Fazio, who knew the old Desert Inn track well, has surprised himself with how dramatically different the course looks. "We took out the grass and created new streams and new lakes. I'm still in awe and amazed we actually did it," Fazio said. "It's so special. If anyone has ever been there before, they'd say it's certainly not where the old golf course was. They'd never believe it."

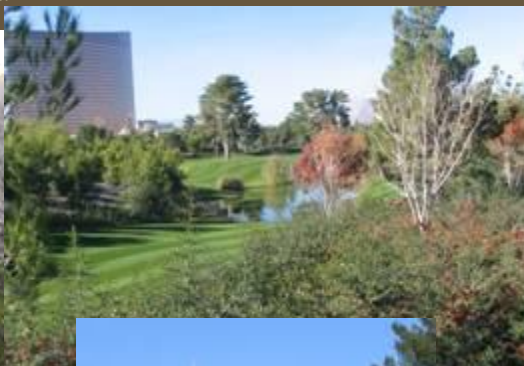



Wethersfield Country Club was incorporated by the State of Connecticut in 1916 for social and athletic purposes. One year later the original "inside nine" holes between Prospect Street and Highland Street were opened and the clubhouse dedicated. In 1925 the Highland Street "outside nine" holes were opened to complete the championship course.

Robert D. Pryde who designed the original golf course, as well as the New Haven, Race Brook, Wyantenuck, and other courses, became the first Executive Director of the Connecticut State Golf Association and was inducted into the Connecticut Golf Hall of Fame in 1999. Because of the superlative play of its members in state and regional competitions over many decades, Wethersfield Country Club came to be known as the "Club of Champions." In 1951 several Wethersfield Country Club members as leaders of the Greater Hartford

Jaycees organized the PGA Tour's Insurance City Open that was first played at WCC on Labor Day weekend, 1952. As the Insurance City Open and later as the Greater Hartford Open, the event was hosted by Wethersfield Country Club from 1952 until 1983 after which it was moved to the TPC course in Cromwell.

Sam Snead won the tournament in 1955, and Arnold Palmer won his first PGA Tour event in the United States at Wethersfield in 1956. Other winners included Tommy Bolt, Billy Casper, Ken Venturi, Dave Stockton, Lee Trevino, and Curtis Strange.

Although he played here several times, Jack Nicklaus never succeeded in winning at Wethersfield. PGA Tour Professionals continue to regard Wethersfield Country Club as one of the best-conditioned golf courses in the country.

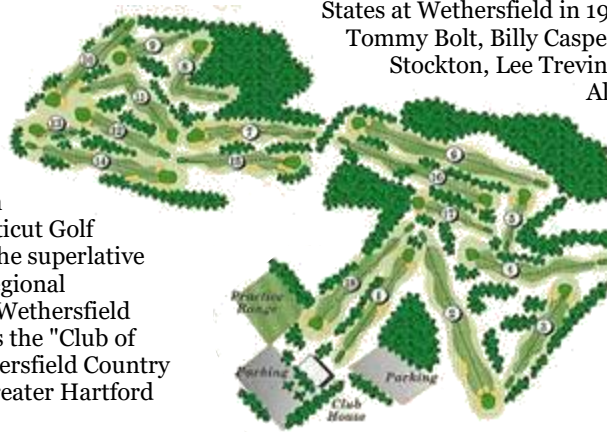



Delray Dunes is a gated country club community located just south of the Palm Beaches and north of Boca Raton. The **Pete Dye** designed course first opened on December 1, 1969. Dye has helped keep the course up to date over the years and returned to guide significant changes that were made to improve the course in 2002.

The superb 18-hole championship course provides open access to the tee and it's always easy to get a game. A round of golf generally takes less than 3 ½ hours. The practice facility is close to the 1st and 10th tees. There is a full-swing practice tee with target greens, a short game area with three target greens and a bunker, and a large putting green. Senior tour professional, Bob Murphy, resides on the property and often uses the practice area when he is not playing on tour or announcing.

Dye, who spends winters in nearby Delray Beach, jokes that this is his "retirement plan," to renovate all his classic older designs, changing greens to accommodate today's green speeds, upgrading irrigation and turf grasses, rethinking strategies and bunker locations and, yes, adding length, so that after he's gone, there'll be no need for people to "screw up" his best works for at least 20 years. In recent years, he's redone his Oak Tree Golf Club, Harbour Town and The Ocean Course, to name drop just a few.



THE BREAKERS®

PALM BEACH



The Breakers **Rees Jones** Course has been recently reconstructed as one of the premier golf experiences in the southeast U.S., reflecting the incomparable new-classic style of eminent golf course architect Rees Jones. From its previous incarnation as Breakers West, the new course has been lengthened to more than 7,100 yards and changed into a par 72 layout. The course is a more contemporary counterpart to the historic Ocean Course.

To get to know The Breakers is to get to know the rich (pardon the pun) history of Palm Beach County. In 1893, railroad magnate Henry Morrison Flagler, a partner of John D. Rockefeller in Standard Oil (now Exxon) purchased 140 acres of land between the Atlantic Ocean and Lake Worth. The next year Flagler opened the Royal Poinciana resort.

In 1896, Flagler built the Palm Beach Inn to hold the overflow crowd from the Royal Poinciana. That same year he also built the Port of Palm Beach, so his guests could travel by steamship to such locales as Key West, Nassau and Havana.

Also in 1896, Flagler hired Alexander J. Findlay to build what is reputed to be the first nine holes of

golf in Florida. The Palm Beach Inn was renamed The Breakers in 1901 because so many guests asked for rooms "down by the breakers."

The Breakers Rees Jones Course is a completely renovated version of Willard Byrd's original Breakers West course. Jones added bunkers and contouring -- primarily on the back nine -- as well as nearly five acres of new lakes in areas previously inhabited by non-indigenous trees. "The Open Doctor" kept native trees, including 450 relocated sable palms and 400 new pine trees. Jones also transplanted 39 oak trees and added another 40.

"The way we staggered some of the bunkers really make you think about what you're capable of doing, so in that way the course plays a little bit longer" than its 7,100 yards (par 72), Jones said. "You might not want to hit driver every time. This is like a neo-classic golf course now. You have to think your way around it instead of trying to just go from Point A to Point B."





The Badlands is a 27-hole facility on the northwest side of town off of the Summerlin Highway, voted 1997 Best of Las Vegas by the Review Journal readers poll and was ranked among the 1997 and 1999 Top Ten Best Courses in Nevada by Golf Digest. The **Johnny Miller**-designed Badlands Golf Club has three distinct nines: the Desperado, Diablo and Outlaw courses that will challenge your game at any level. This fascinating course was built in 1995 and was a collaborative effort between as unusual a mix of personalities imaginable, **Miller** and **Chi Chi Rodriguez**. Miller, the former tour player and golf's premier television talking head also has developed a substantial golf architectural firm. Chi Chi Rodriguez, a stalwart tour player and Senior Tour star, has for years beat the drum for the love of the game of golf.

From the clubhouse your first site is of the stark tan hues of the landscape framing ribbons of green grass that seem to be poured between the hardened ground. This is true desert golf in a rugged setting. Toss in a little breeze and simmer over the Southern Nevada heat and you have all of the elements for challenging golf.

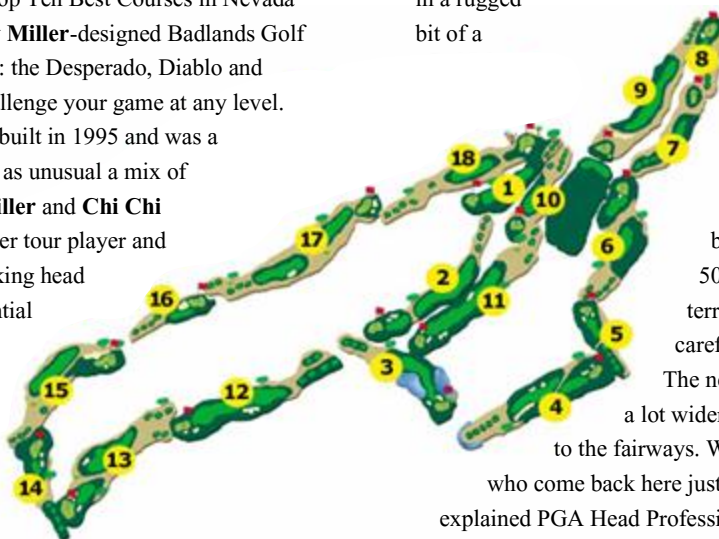

“This course is demanding but fair. The original nines are 50% fairway and 50% natural terrain and you have to be careful where you hit your shots. The new nine, The Outlaw Nine, is a lot wider and funnels your shots back to the fairways. We get a lot of repeat players who come back here just to conquer our course,” explained PGA Head Professional Jeff Levin.





Located in the McCullough Mountains, high above the Las Vegas Valley floor, DragonRidge is a unique private Country Club that offers features unsurpassed in Southern Nevada. The golf course design of DragonRidge marks the first collaboration between award-winning architect **Jay Morrish** and rising architect **David Druzisky**. The philosophy Morrish and Druzisky shared in designing the course was to make it playable for all skill levels, but to always keep players off balance. Since 1964, Jay Morrish has



been active in golf course design. During his career he has worked with such legends as Robert Trent Jones, George Fazio and Jack Nicklaus. Morrish is best known for his long-time partnership with Tom Weiskopf. Together, Weiskopf and Morrish designed several golf

courses recognized in the Top 100 in both the U.S. and around the world. Their collaboration includes Troon and Troon North Golf and Country Club in Scottsdale, Arizona; Forest Highlands in Flagstaff, Arizona; Shadow Glen in Olathe, Kansas; Double Eagle Club in Galena, Ohio and Scotland's Loch Lomond. Collectively, these courses have hosted numerous PGA tournaments, including the U.S. and British Opens.





Great Waters at Reynolds Plantation

Anytime **Jack Nicklaus** unveils one of his signature courses, it is big news in the golf world. But in the fall of 1992, when Great Waters at Reynolds Plantation opened, it stirred a rush of excitement within the golf community that was extraordinary, even by Nicklaus standards.

The Great Waters Course, a 7,048-yard, par 72 layout, offers players some of the most dramatic golf scenery in the Southeast. With nine holes lining the shores of Lake Oconee, Great Waters offers both exciting challenges and beautiful views. Great Waters winds through densely wooded evergreen corridors only to open up to nine holes featuring the blue waters of Lake Oconee as the rough. Named as one of the best courses in Georgia, second only to Augusta National, Great Waters proves to be one of the most aesthetically inspiring golf courses in the continental United States. It remains the finest course on the property now 14 years old. The final hole on the front side

provides a taste of the drama to come. This downhill par-4 with an approach over the lake is a microcosm of what lies ahead, and helps to showcase why Great Waters is the must-play course at Reynolds.



The course's signature hole is No. 5, a downhill, 562-yard par-5. Emerging from the forested fairway, the green is backed by Lake Oconee. Hole No. 2, a short downhill 356-yard par-4, and No. 16, a 478-yard par 5, are also memorable.

"Great Waters is one of the most user friendly courses Jack has built to date."

Brian McCallen, Golf Magazine

"This may be Nicklaus' best all around work to date. Great Waters has nine holes slammed against the banks of Lake Oconee and the entire course is outlined with Georgia Pines. It's a must play..."

Charley Stine, Golfweek

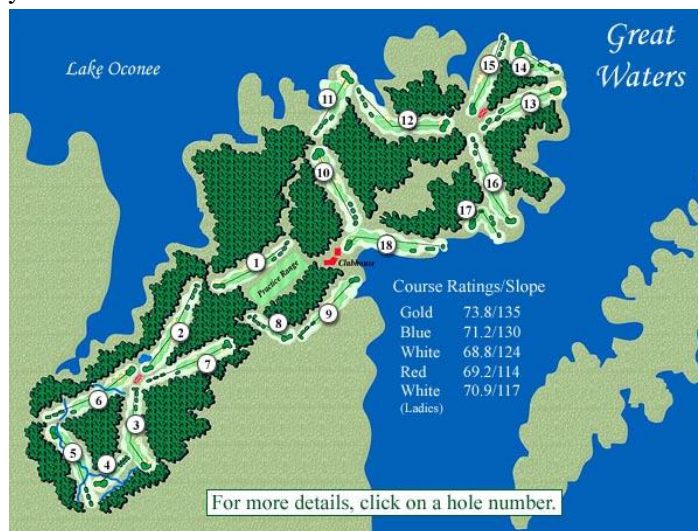



Ask Head Pro Scott Scherger to tell you a little bit about the signature hole at Dinosaur Mountain, and he'll ask you if you have a while, because he has about twelve he could talk about. Now, every head pro says the same about his own respective course, but the only problem is, this time it was as true as the greens that grace the ends of the fairways at the Dinosaur Mountain Golf Course. While Scherger would decide upon the par-4 12th Hole, after heading out for a round, you'll be ready to give the honors to two thirds of the holes on the course.

"Bring your 'A' game and your camera" gush nature lovers at this "out of the way, but worth it" resort track amid the ghost towns east of Phoenix that delights the eye with "huge elevation changes" and splendid "high-desert views" of the Superstition Mountains"; even zoologists would admit "it's a challenge keeping your eye on the ball while

watching" "roadrunners, bobcats, javelinas" and "more jackrabbits than an Easter special" "frolic in the fairway" but besides the critters, there's "no one on the course."



Dinosaur Mountain

The Dinosaur Mountain course designed by **Ken Kavanaugh**, and ranked the #1 Public Golf Course in Arizona for two consecutive years, takes golfers into the high Sonoran desert environment. This golf course wraps around and over picturesque Dinosaur Mountain - a foothill of the spectacular Superstition Mountains. A

round of golf includes magnificent views of the Superstition Mountains, dramatic tee-to-green elevation changes and long, loping fairways that are breathtaking. And the views from holes 4 and 5 will lure you back time and again to this incredible golf course.

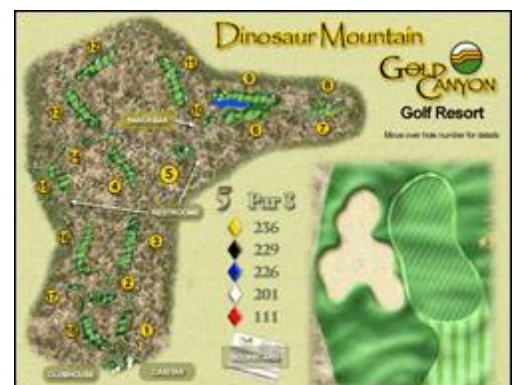
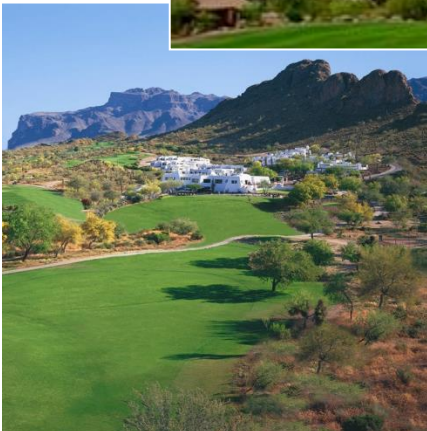



Grayhawk Talon



Scottsdale's acclaimed Grayhawk Golf Club offers two of the Southwest's most enjoyable and challenging golf experiences. In fact, the 6,973-yard, par-72 **Talon** Course, designed by former PGA and US Open Champion **David Graham** and architect **Gary Panks**,

was selected as one of Golf Magazine's "Top 10 You Can Play."

The Talon course is a mature desert layout that features an abundance of landscaped foliage, including thoughtfully designed tee areas decorated with gorgeous wildflowers. And oh yes – the surrounding desert and mountains form postcard perfect backdrops and panoramic views on the majority of holes. Many of the green complexes provide sufficient level areas and afford opportunities for bump and run saves, from approaches landing short of the beautiful Crenshaw bent grass greens. The first five holes afford golfers an opportunity to get their game together before confronting the course's number one handicap. A short carry over desert will find an extremely undulating fairway on this long par four. The second shot plays uphill with significant room greenside.



Seventeen is a pretty par three that for all practical purposes, amounts to an island green. There is some right, but golfers will find their wedge game challenged here. Eighteen is a beautiful finishing hole that

begins with a short desert carry to a wide fairway bound by sand traps on the right side.

The water along the left should not hamper the second shot, but must be taken into consideration on the approach, as it rests immediately left of the putting surface. Four sets of tee boxes allow golfers to choose from yardages and slopes measuring 6973//143, 6391/133, 5867/120 slope for men and 133 slope for women, and 5143 yards/121 slope.



Photo by: Mike Kemme

TOURNAMENTS

1995, 1996, 1998 Host of the Andersen Consulting World Championship of Golf

AWARDS

GOLF Magazine "Top 10 You Can Play." 1995

#5 Arizona Republic "Top 25 Public Golf Courses." 1996

#78 GOLF Magazine "Top 100 You Can Play." 2002





RANCHO MAÑANA GOLF CLUB, located in the heart of the Sonoran Desert in historic Cave Creek, Arizona, features a par 70, championship course with dramatic elevation changes and unspoiled desert terrain. This stunning, high desert course invites you to match your skills against nature while enjoying the unparalleled and unforgettable surrounding desert. It's where Mother Nature plays!

Once a supply depot for the US Cavalry in the 1860's, Cave Creek gradually settled and took root amidst early miners and cowboys. In the 1920's, out of the desire of city-weary Easterners to experience the "Real West", a new attraction emerged and the first guest or "dude" ranch was introduced. In 1943 Rancho Mañana got its name. It's Spanish for "ranch of tomorrow". Different from the rest, Rancho Mañana resembled a Spanish hacienda complete with casitas and a cantina. So wildly popular was Rancho Mañana, even royalty and movie stars have come to stay! Many changes and transformations have taken place at Rancho Mañana over the years, however, the legend still lives on.

As far as the golf course, it was designed by **Bill Johnston**. The overwhelming characteristic of the layout is the tightness of the fairways, with desert usually bordering both sides. The course is not long (just over 6000 yards from the blues) so if you can hit 'em straight, you can score very well here and there are very few blind shots – you can usually see what you are getting into.

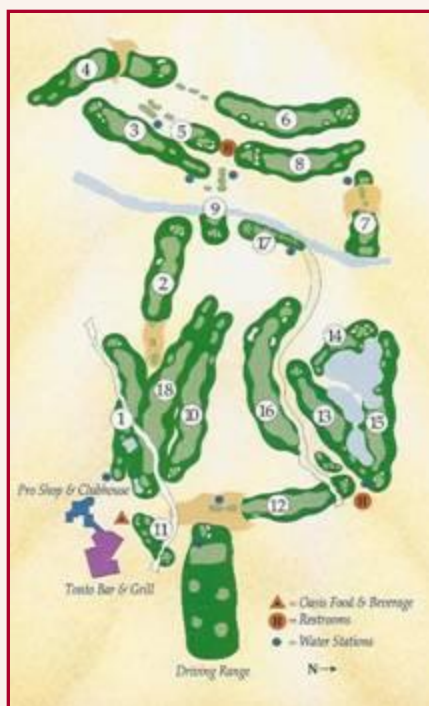

Golf Digest "Places to Play"

"Voted One of Arizona's Most Scenic Golf Courses"

© Copyright 2002, Allred Capital, L.L.P. All Rights Reserved



In the tradition of Royal Lytham, St Anne's Old Links and other famous seaside courses in the British Isles, Twisted Dune Golf Club is a first class links even though it's not on the ocean. Laid out through rolling sand dunes and almost devoid of trees it's easy to forget you

are just minutes away from the action in Atlantic City, and not tucked away deep in the Scottish Highlands. The layout of Twisted Dune takes into account the factor the wind will play on the course and allows the player the option of running the ball up or flying it onto the greens.

This tests the player's ability with shots seldom called for on ordinary courses. The bent grass turf that carpets each fairway offers players the perfect firm surface from which to strike a crisp approach. Sand dunes frame each of the generous fairways, but will test both the players' skill and



temperament should his ball find itself among them. Adding to the challenge on each hole is a host of fiendish bunkers along with carnivorous waste areas that wait to devour any ball that strays too far off line! A fearsome 7,336 yards from the

Once a mecca only for gamblers and retired Elvis impersonators, Atlantic City has become a sure bet as one of the East Coast's top golfing destinations.



Newcomer Twisted Dune is known for its "Scottish style" links and wide fairways laid out among the rolling sand dunes.
Photo: L.C. Lambrecht

Dune is public golf course that looks and feels like one of the world's finest private clubs, leaving you with the memorable impression of having played and enjoyed a special golfing experience.

"I wanted to replicate a kind of Irish look," said **Archie Struthers**, the designer. "I tried to build a modern course that looks like it occurred rather than being built."

Struthers is quite a character, a former caddie and assistant pro at Pine Valley, who has gone on to become the managing partner of the company that owns Greate Bay and now, with Twisted Dune, a developer.



Until Twisted Dune, Struthers never had designed a course, and he didn't intend to design this one. Originally, with substantial financial backing, he hired Rees Jones, one of the top architects working today. Jones' company produced an initial routing plan. But Jones, who never visited the property, and Twisted Dunes soon parted company, and the resulting course is emphatically not a Jones design.

"We weren't on the same page," said Struthers, preferring not to discuss the matter further. "This is not a Rees Jones course."

Struthers stepped into the design breach. Lacking formal



challenge of the PGA Tour. The large greens, once reached, offer ample opportunity for birdies! With such smooth rolling surfaces the player has no one but himself to blame should the ball not fall into the cup.

Twisted Dune is a players club, one where every golfer can enjoy the total golf experience. Caddies, carts and fore caddies will be available giving each group the choice of walking, riding or a little of both. Tee times are further apart than at traditional clubs and play will be limited to insure each foursome rarely ever sees the people in front or behind them. In short, Twisted

training, Struthers relied largely on his own instincts and some of the design philosophy tips he overheard during those seven years as a caddie at Pine Valley while toting the bags of some of the greats, among them Tom Fazio, Arnold Palmer, Jack Nicklaus and Ben Crenshaw.

Twisted Dunes is ranked #4 in New Jersey by *Golfer's Dream* Magazine readers in its "2003 Top 100 Public Access Courses" poll.



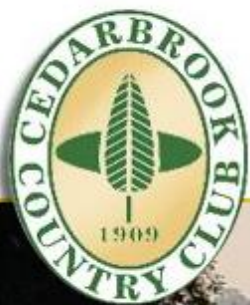

Welcome to *Cedarbrook Country Club*



Today's Cedarbrook Country Club is a direct outgrowth of Stenton Country Club, which was founded in 1909 and played its golf on leased ground near Stenton Avenue and Washington Lane in the Chestnut Hill section of the city. But within ten years this land had grown substantially in value. Unable to renew its lease, the club examined a number of sites in North Philadelphia, and in 1919 purchased a tract known then as Cedarbrook Farm. It was bounded by Cheltenham Avenue, Easton Rd.,

and Limekiln Turnpike.

A.W. Tillinghast was commissioned to lay out the course. Though most of the designs for which he would become celebrated were still several years in the future, he had already fashioned two of his best, the eighteens at San Francisco Golf Club and at Somerset Hills, in northern New Jersey. On the 4th of July, 1921, the course and clubhouse in Cheltenham Township were formally opened.



J. Hampton Moore, Mayor of Philadelphia, personally raised the club emblem to the top of the flagpole and, in a brief address, predicted a long and prosperous life for Cedarbrook. He did not guarantee that the club would stay put. It was in the late 1920s that Donald Ross was brought in to revise the Tillinghast design. By and large, the original routing plan was retained. But holes were

lengthened, bunkering was made more stringent, and a creek brought more prominently into play. One of only two Philadelphia courses designed by the great Tillinghast now also bore the stamp of the great Ross. In 1955 the Commonwealth of Pennsylvania, as part of its highway program, acquired, through condemnation, 20 1/2 acres of Cedarbrook's land for use in the construction of the Route 309 Expressway. Serious consideration was at first given to revising the course and rehabilitating the clubhouse, but in September, 1958, a resolution to sell the property for the specific purpose of relocation was passed by the membership.

Four years later, in 1962, a new Cedarbrook course designed by **William F. Mitchell** with **William F. Gordon**, of Doylestown, would open in Blue Bell.





When one talks about the history of a golf course, all you have to do is look at what championships have been staged at the venue to know where it ranks among the greats. That certainly is the case with Congressional Country Club. From the U.S. and Senior Opens and PGA Championship, along with PGA Tour stops, Congressional is as storied a club as it gets.

Founded in 1924, Congressional was first laid out by **Devereaux Emmet**. With most of his work done in the state of New York, Emmet's work at Congressional, nine holes each of the Blue and Gold, was his only design in the state of Maryland. Six years later, the one and only Donald Ross was brought in for a revision of the course.



Congressional Country Club was the centerpiece for one of the world's most famous regions, Washington D.C.

Congressmen Oscar E. Bland and O.R. Luhring of Indiana helped found the venue with Herbert Hoover as the Club's first president. Congressional is synonymous with the Presidents of the United States. Former Commanders-in-Chief who were lifetime members were Calvin Coolidge, Howard Taft, Hoover, Woodrow Wilson and Warren Harding. President Dwight Eisenhower and his Cabinet frequented the lush fairways on many occasions, as did recent leaders George Bush and Bill Clinton.

Congressional's Blue Course has received the most notoriety,



having hosted two United States Opens, a Senior US Open, a PGA Championship and the area's annual PGA Tour stop, the Kemper Open (now the Capital Open, played at TPC Avenel, just down the road) for seven years. But the Gold Course has also received some attention lately, of the upgrade variety. It seems the course needed a bit of a facelift to allow it to compete for members' favor, and course architect Arthur Hills, who's renovated a dozen or so Washington area private clubs, was the perfect man for the job.



Hills tells the story: "Though the Gold Course contained half of the club's original holes, it was probably viewed as the Cinderella of the two courses there. The membership seemed to favor the Blue Course, and when guests came in, they always wanted to play that course – so there was a disproportionate amount of play on the Blue Course."

As Hills alluded to, the Club's original 18 holes were built in the 1924, designed by Gilded Age course architect Devereux Emmet. After WW II, a third nine was added (1957), designed by Robert Trent Jones, who also reworked what became the Blue Course's front nine. The Gold Course's back nine was added in 1977, designed by George and Tom Fazio, then tinkered with over the years by different architects, including Ed Ault of Ault, Clark & Associates. All in all, the changes Hills made to the timeless classic Gold Course are becoming more and more seamless as the days pass by. What exists is a very beautiful, playable, enjoyable golf course. After experiencing it, you'll see that Gold can shine just as well as blue.

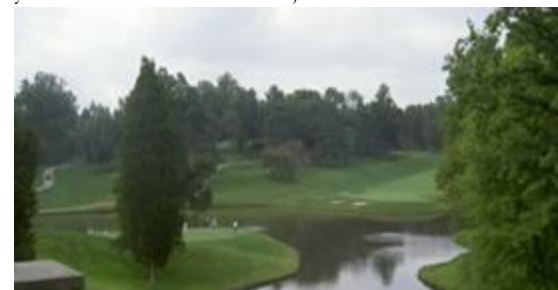

Booz|AllenClassic





A championship caliber course, the Golf Club at Thanksgiving Point is 7,728 yards long and covers more than 200 acres, making it the largest golf club in the state. Ranked in the top ten new courses in the country by Golf Digest in 1997, Thanksgiving Point was recently named the number one public Utah by Golf Digest and one of fifteen "hidden gems" in the country by Links Magazine. This **Johnny Miller** Signature Golf Club cradles the most spectacular gardens in Utah, and creatively uses the natural mountain desert landscape to enhance the overall golf experience.

It's difficult to be modest when describing the Golf Club at Thanksgiving Point. Already this young course has received numerous awards and accolades from the golf industry. For four years, golfers from all over the world have gathered at the most talked-about course in Utah.

Is the Golf Club at Thanksgiving Point really that good? Absolutely! Johnny Miller did a tremendous job creating a picturesque and challenging golf experience. It's the greens,

and the fairways, and the bunkers that we are most proud of. It's the stunning mountain backdrops and the incredibly long layout. It's the fact that many of the world's top golfers (Jack Nicklaus, Johnny Miller, Lee Trevino, Billy Casper, Craig Stadler, Hale Irwin, Gary Player, Fuzzy Zoeller, John Daly, Jim Furyk, Sergio Garcia, and others) have played and loved the course.

Thanksgiving Point is about a lot more than just golf. Visitors from around the state and the country come here to not only shoot a round of golf but to share a peculiar stare with a llama, enjoy a leisurely afternoon in the gardens, watch aliens and creatures of the ocean rumble across the six-story-tall screen at the Mammoth Screen Theater or gaze at the 60 skeletal exhibits in the museum. And while they're here, visitors enjoy entertainment in one of three great venues: the 34-acre open-air pavilion, Barn Theatre, and Waterfall Amphitheater.

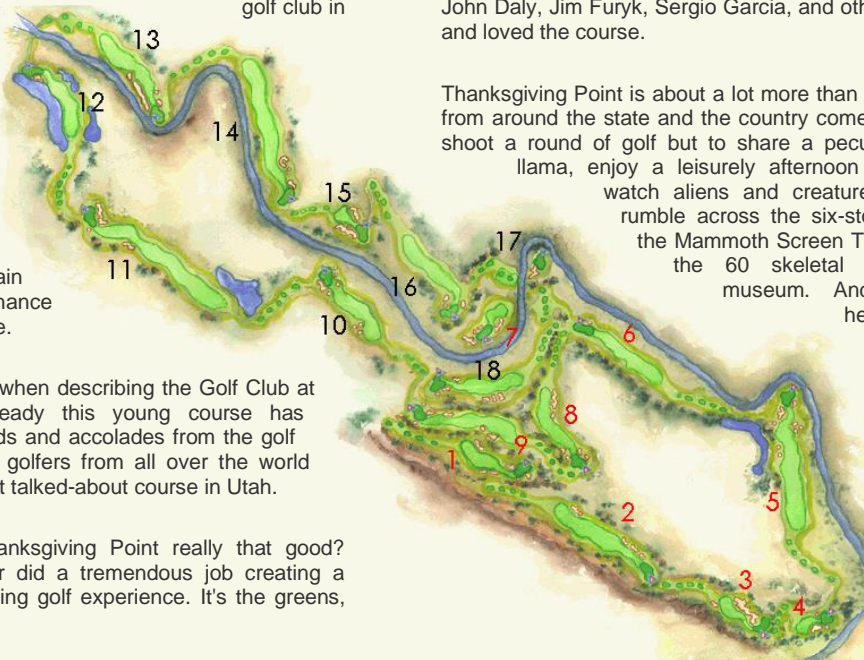



Bountiful Ridge Golf Club

Bountiful Ridge is a par 71 municipal course of majestic wide open beauty. Bountiful rests atop the mountains surrounding Salt Lake City. It is not a normal stop on the tour, but its wild setting, large tantalizing fairways and challenging greens provide an unaccustomed treat for the Pros. Scoring here can be low, but if the greens are dry and hard, golfers beware. The sharp breaks and unusual elevations are treacherous. A poorly judged putt can cause misery and embarrassment as well as a ruined round. All three par-5's are reachable in two and several of the par-4's are short. The fourth and eleventh though, are exceptionally difficult. The 422 yard fourth is a sharp dogleg left where judging the flight of the ball around the sharp corner, uphill and in the wind, to a shallow fairway demands perfect execution. The 449 yard eleventh offers another uphill drive to a dogleg right. If the drive is short or too far right reaching the green over the shaggy cedars in two is almost impossible. The finishing hole, a Par-5 at 485 yards can be easily reached, but the approach is all carry over a deep ravine gully in the fairway and two deep grassy depressions. The two-tiered green is demonically tricky. Any putt from above the hole is in danger of rolling all the way off the green. There have been some dramatic finishes there. Mountain goats, deer and rabbits are frequently seen roaming about, and with majestic views of the Great Salt Lake, this picturesque little course is a welcome diversion from the tight formality of the regular tour.



Dir. of Golf: Kent McComb

Superintendent: Chuck Goode

Year Built: 1975

Grass Types: *Greens:* Bent Grass, *Fairways:* Blue Grass, Rye, Fescue m, *Tees:* Blue Grass, Rye mix, *Rough:* Blue Grass, Rye, Fescue

Hours of operation: Dawn to Dusk, All Week

Normal Season: March through November

Course Style: N/A

Designer: William H. Neff



Bountiful Ridge Golf Course





SOMERSETT COUNTRY CLUB



Somerset Country Club, located in West Reno's exciting new master planned golf community is being developed in the traditional manner of a fine private club. Somerset Country Club features a **Tom Kite** signature 18-hole Championship Course with breathtaking elevation changes and views of the Sierra Nevada from every hole. The par 72 course plays

to 7,252 yards from its championship tees and incorporates several lakes, waterfalls, wooden bridges, beautiful white sand bunkers, extra-wide landing areas, and five sets of tees per hole to accommodate all skill levels. With fairways lined with majestic mountain views and splashes of colorful vegetation, the Somerset Country Club perfectly harmonizes with the Sierra Nevada landscape.



The course opens with a stunning downhill tee shot between broad sets of bunkers. It's a drive that sets a quick and definite tone for the round to come: Plenty of elevation changes from tee to green, landing areas that are much more generous than they appear at first glance, and approaches to big, sweeping greens that are already in amazing shape.

Potential signature

holes abound, but Kurt Vogel, Somerset's head golf professional, gives his nod to No. 5 — a 588-yard par 5 that snakes between two lakes.

"From the elevated tee, the more you look at that tight landing area, the narrower it gets — especially when the wind kicks up."



For Hughes, No. 16 does the trick. "To me it's the most intimidating hole out here. You get up on the tee and all you see is bunkers, but when you get up to the green and look back, you can't see any of them. That's the mark of a great hole."



In fact, there's no hint of a weak hole at Somerset. Kite's first Northern Nevada effort excels at every level — it's playable for all comers and downright friendly for everyone who picks the right tee. There's five to choose from, giving

this course several personalities. It's the kind of layout that will stir the juices every time, even if you play it every day. That's an important factor at any private club, and what Kite had in mind from the start. Less well known, but rapidly changing, is his work in golf course design. Tom only takes on projects when he knows that his schedule will allow his full participation in the project. While he is highly involved in all phases of a project, he focuses on green design and course strategy.

**Other Kite Bechtol
Russell golf courses
include:**

- Comanche Trace
- Gaillardia
- Legends





Encinitas Ranch offers 18 championship holes in a unique setting carved from a magnificent sweep of bluffs overlooking the Pacific Ocean. Golfers are greeted by the wide, forgiving fairways on the front nine, but will find the back nine requiring precise tee shots for lower scores. Dramatic elevation changes add excitement to an already challenging course, while four sets of tees accommodate golfers of all levels. The first thing that strikes you as you enter course are the

vibrant flowers along the 11th. It's not a showy flowerbed like on the famous Flower Hole, the 16th at Wisconsin's Sentry-World. Here, there are rows of flowering bushes that bracket the par-3 hole. They preview what's to come. Out on the front nine, there's a whole hillside of still-working flower fields with rows upon rows of flowering bushes to the left of the opening holes. On the back nine, clusters of flowering plants are accents. That's not the only reminder of the previous flower ranch once found on the property. The entire course has the look and feel of a very good Billy Bell course (Bell Sr. and Jr. being the

premier public course designers in Southern California for half a century), and I mean that as a compliment. The shaping is more pronounced than on a Bell design. Architect **Cary Bickley** said he wanted it to appear that all the mounds and bunkers were shaped by the wind, and they do, especially when the sun begins to set. Overall, Encinitas

Ranch has the broad,

appealing landscape that promises playability and delivers a decent

score.

Perhaps its most distinctive feature involves its graceful fairway bunkers. All are set in mounds and are raised slightly above the level of the fairways. I remember asking Cary if that was for drainage. Yes, he said, plus the fact that he didn't want average golf shots rolling off a fairway and into his bunkers. If a golfer flies a shot into one of his bunkers, that's okay. But he didn't want good drives to suddenly scurry into sand pits. For locals, its San Diego neighbor, Torrey Pines is the better bargain, but for an out-of-towner, Encinitas is the better value, a quicker round and an equally enjoyable test of golf.



PASATIEMPO



If **Alister MacKenzie** were alive today, he would still live at Pasatiempo. Nothing has transpired there in the past 70 years that would have made him move, and overall, the course remains as he intended: open to the public and a challenge for the very best.

Imagine MacKenzie's excitement when he first saw the property: gently rolling hills bisected in spots by sandy ravines, a large barranca and a stream. Stately oaks



dotted the landscape, and there were views from the course out to the shimmering blue Monterey Bay. In addition, MacKenzie would be working for Marion Hollins and her only mission statement to him was to build a course equal to any in the country - and she had the money to help.

The one-shot holes at Pasatiempo are of great variety — from the finely judged pitch of the 15th to the full-bloodied thump required at the 3rd hole. In addition, the two shot holes taken as a collection are superb and for difficulty, exceed those at MacKenzie's Monterey masterpiece.

Interestingly enough, two favorite par fours weren't designed that way to begin with. Originally, MacKenzie designed the 2nd and 10th holes as par fives. However, when their respective tees were moved across the road, they became tough half-par holes. These difficult par fours are well



Pasatiempo 2006

complimented by holes under 400 yards of unusual quality: the beautiful 4th from its elevated tee, the 11th and 12th holes and of course the famous 16th hole.

Each hole is different, even similarly length holes like the 2nd and 10th. The 2nd green is slender but a full 34 yards in depth with three bunkers around it. The 10th green is bunkerless and squatter, being more wide (26 yards) than deep (a mere 23 yards). Mackenzie successfully punctuates each hole at Pasatiempo with its own unique challenge. These greens have withstood the test of time and remain vastly unchanged; golfers should make every effort to see them.

In recent times, Pasatiempo Golf Club

has undertaken a bunker restoration and a much needed tree removal program. Visually, the white sand against the dark fir trees is quite striking. Even though the course is far more verdant and less sandy (the par three 3rd hole once had 13 bunkers on it), Marion Hollins would be proud of the appearance of the course today. She loved trees and the logo with a man underneath a tree 'passing the time' would please her. She and her dog Carlos would still enjoy their walks across the property as much as they did in 1929.





Lionhead Golf and Country Club

8525 Mississauga Road, Brampton, Ontario (905) 455-8400

The Legends

Designed and groomed to excite every level of golfer, Lionhead offers its guests one of Ontario's finest golfing experiences on two championship courses. The Legends course is designed to stir your spirit, exceed expectations and defy understanding. It is an exhilarating challenge of golf. Nestled in the beautiful Credit River Valley the Legends course offers a challenge to all golfing abilities. On the course you will find shimmering lakes, deep Ohio sand bunkers, inviting bent grass fairways and impeccable bent grass greens. Every hole on the course is designed to give a golfer the "WOW!" effect. Canadian course architect **Ted Baker** made his reputation at the Legends course at the 36-hole Lionhead Golf Club in Brampton, Ontario. At Lionhead, the course owner instructed Baker to, "Make it the most private public golf facility in Canada and make it tough." Baker was successful on both counts and Golf Digest has ranked the Legends course as third toughest public course in North America.

****LEGENDS RATED #1** by Ontario Golf (Mid-Summer Edition 2004) In their ranking of "Ontario's 20 Highest Course Ratings" and "Ontario's 20 Highest Slope Ratings".

- > Rated 3rd toughest golf course in North America (*Golf Digest*)





Ted Robinson is the genius that created the Ocotillo masterpiece. The lush, rolling fairways abundantly sprinkled with mature trees, colorful flower beds, water falls and lakes come into play on nearly every hole. Ocotillo Golf Club has superb 27-hole championship course that has become one of -if not the -finest upscale daily fee facilities in the country.



The Ocotillo golf course offers amenities that are normally found in the finest private clubs. Once you arrive at Ocotillo Golf Club regardless if you have traveled around the world or live within walking distance the staff will treat you like you as if you owned the place.



Water runs along the entire left bank of this conquest leading up to green-side construction of rocky waterfalls. Beautiful and refined, Ocotillo's contemporary clubhouse has an elegant outdoor patio surrounded by water falls, streams and a myriad of flower beds, inside arched ceilings and beams soar 30 feet above.

Luxurious and delicious, Ocotillo's guests can select from fine dining (evening) or a casual bar. Ocotillo has three different nines: a Blue, Gold and a White.

Expect to fall in love on the Blue course. Running water splashing against sharp rocks as birds flap their wings against the freshly trimmed grass on the fairways.

